

A Project Done With Old Fashion Values With A Twist **Trust, Honesty, Professionalism and ...**



The University of Kansas
Multidisciplinary Research Building

2006 AUA Conference

By Warren Corman and Jim Modig

Weathering a Storm of a Different Kind

The Driving Force

- Goal to be a top 25 research institution
- Potential to expand world-class research programs
- Opportunity to increase research overhead funding
- Increased opportunity for more grants sooner



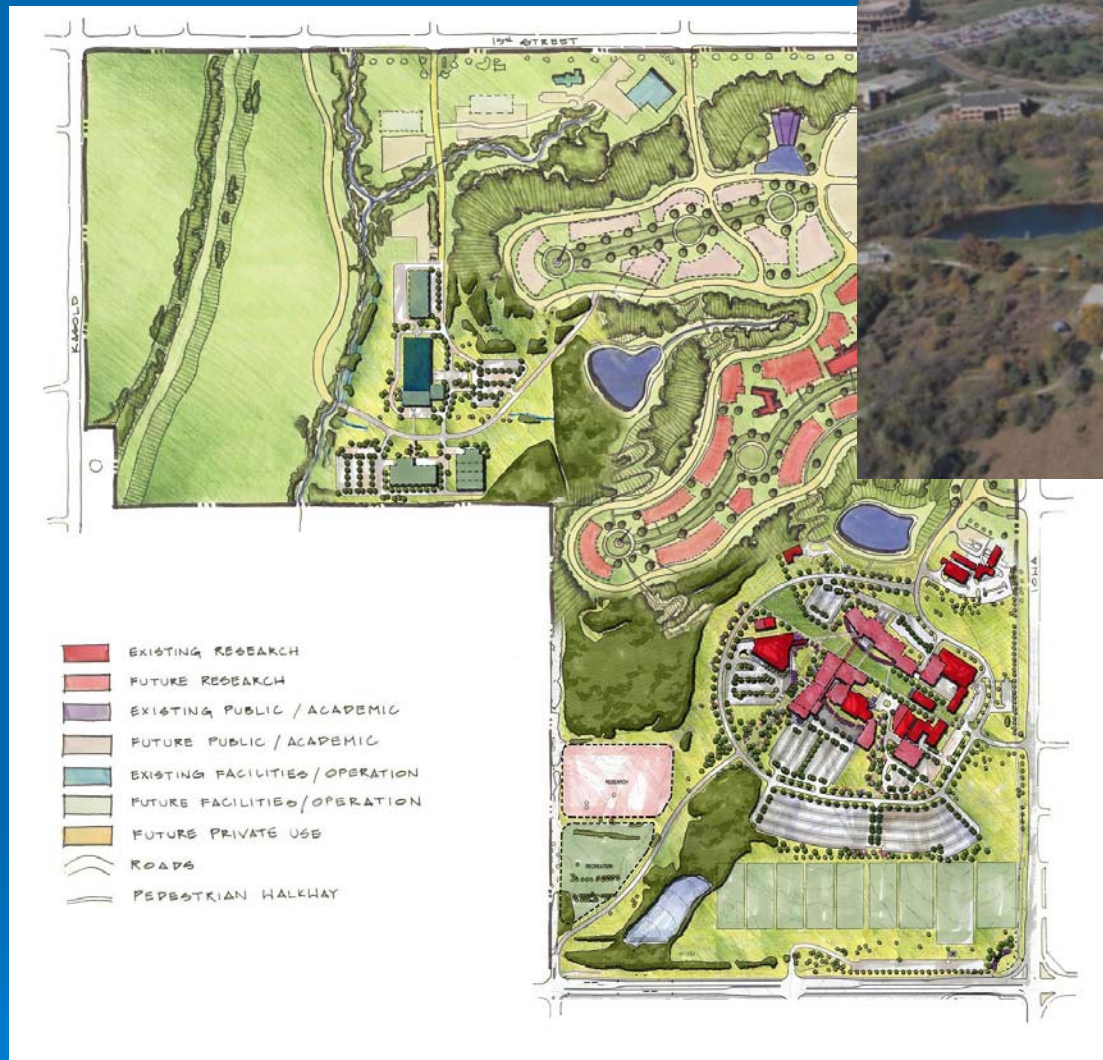

West Campus Revised Master Plan

Site Environmental Issues

Ephemeral Stream Review

Wetlands Issue

Wildlife or Endangered Species – Frogs?



November 17, 2004

A/E Selection and Project Approach

- Proven experienced consultants
 - Consultants intimately knowledgeable of the campus
 - No time for learning curve
 - Partnering cemented focus on goals
 - Early development of mutual respect for everyone's role
- 
- A decorative graphic in the bottom right corner of the slide, consisting of several concentric circles in shades of blue, resembling ripples in water.

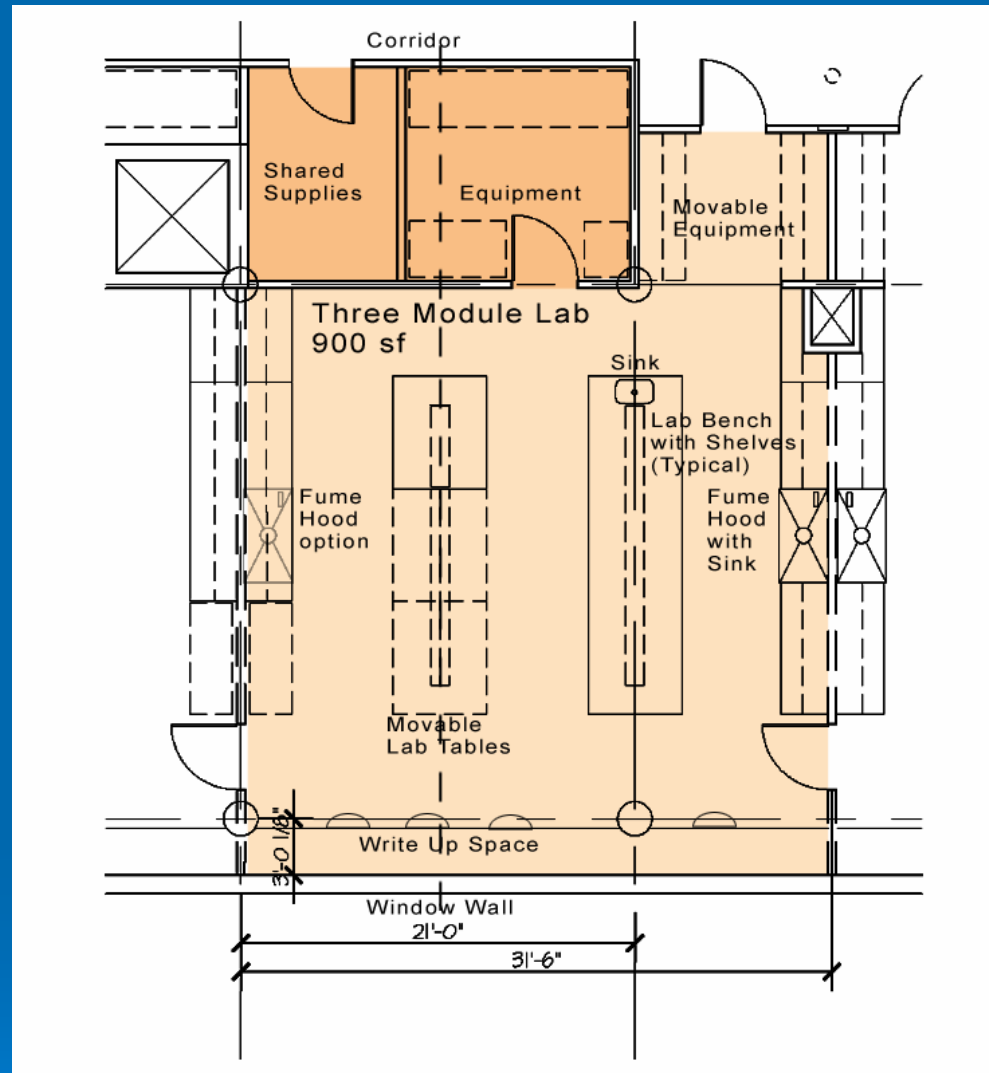
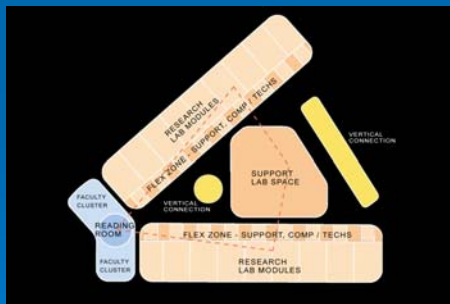
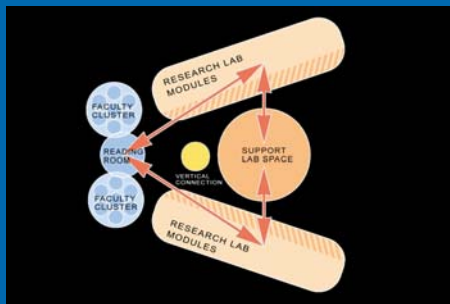
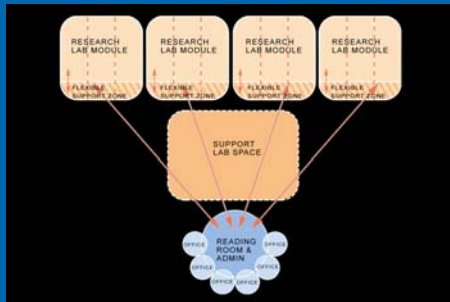

Lab Module

October 2004



Typical Floor Plan

October 2004

Schedule

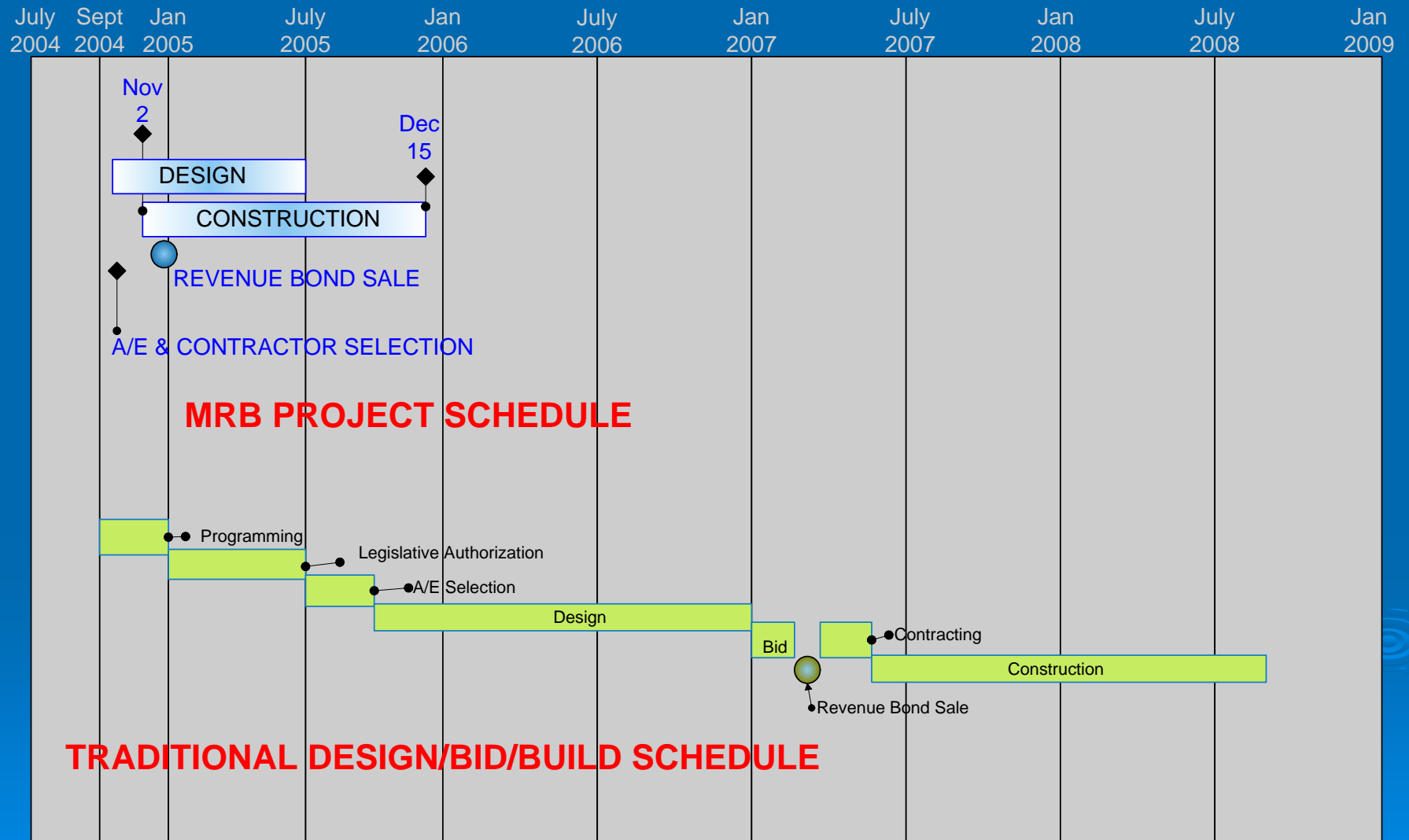

Progress

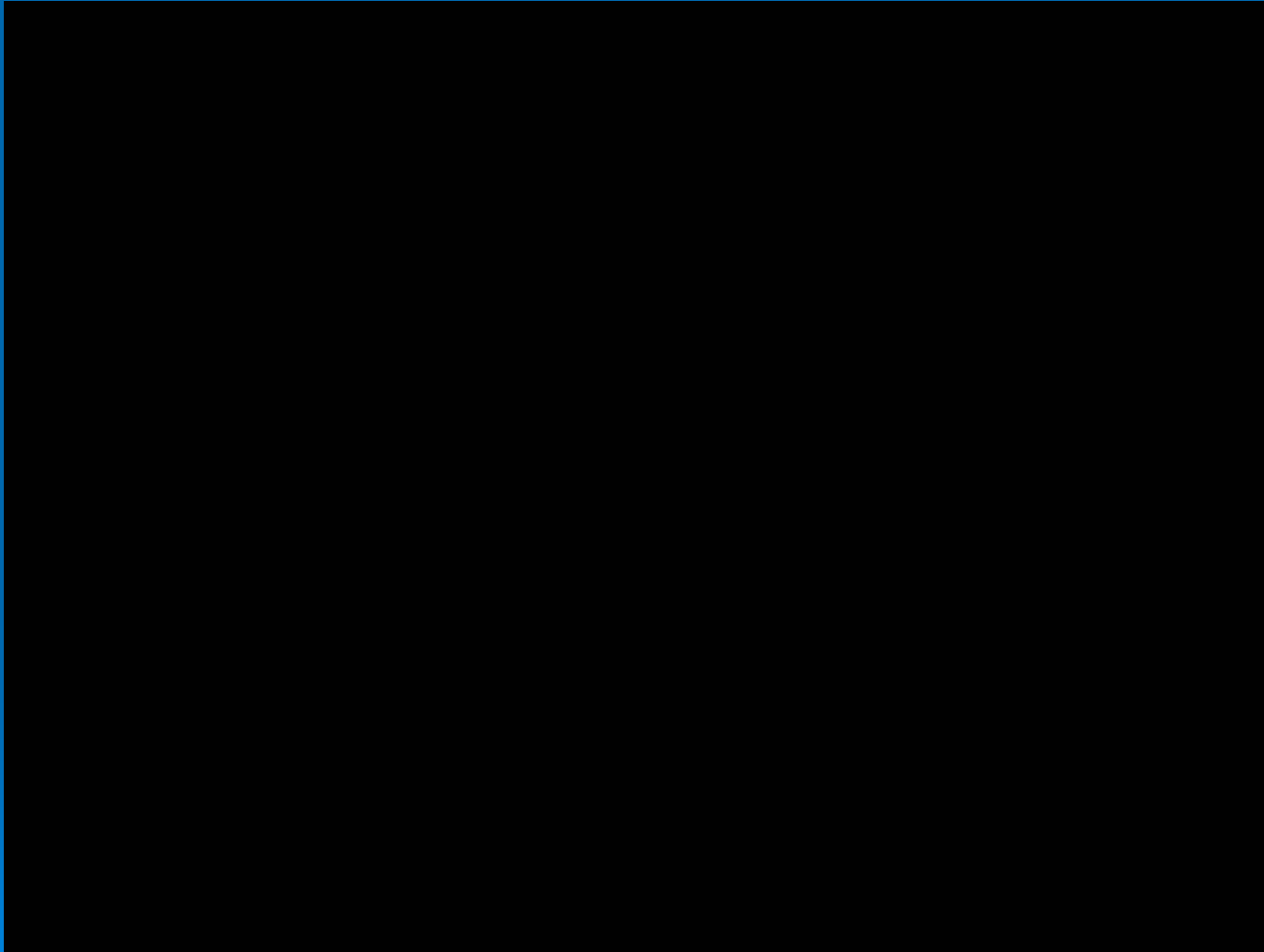

Video by Scott Oliver a Junior at Blue Valley North High School

Final Showdown

Final Acceptance and Occupancy Permit



Occupancy Permit with Stipulations

December 16, 2005

Lessons Learned

- **Solution Oriented Attitude – Be Goal Focused**
- **Time is Money - \$6 mil inflation savings, \$4 mil in increased research overhead & opportunity for more grants approx. \$12 mil**
- **Trust, Honesty, Professionalism and accelerated schedule can work.**
- **Team Effort – 100%**
- **Accelerated Schedule did not compromise stewardship of project funding, master plan or quality of the facility**
- **Compatibility and cooperation a key factor**



QUESTIONS ?