

## CSU Channel Islands Campus *"From Containment to Collaboration"*



## Agenda

1. Campus History
2. Campus Facts
3. Hospital Planning Strategies
4. Transform to a New University
5. Lessons Learned/Moving Forward



## Campus History

- Chumash Nation
- Mexican Rancho 18<sup>th</sup> C
- Agricultural Land Use
- Camarillo State Mental Hospital 1930's
  - Over 7,000 "client" population
  - Largest WPA project west of Mississippi
- CSU Northridge Satellite Campus 1998
- CSU Channel Islands – 23<sup>rd</sup> campus in CSU 2002



## Campus Facts

- 1187 Acres Total
  - Arcadian setting at the base of the coastal mountains
- 225 Acres Developable Land
  - Site Authority Lease
  - Faculty/Staff Housing
  - Land in a FEMA flood plain
  - Sacred Chumash site (Round Mountain)
  - University Park
- 1.5 Million GSF of Total Building Stock
  - Renovated, new and unoccupied
  - Occupy 65% of buildings
- Current Enrollment – 4,000 FTEs (fall '12)
- Maximum Enrollment – 15,000 FTEs





## Hospital Planning Strategies



## Hospital Planning Strategies

- Isolated from Populated Areas
  - At the base of the Santa Monica Mountains
- Self Sustainable Facility
  - Buildings designed for natural ventilation & light
  - Maximize connections to the outside
- Designed to Contain & Isolate the Clients
  - Layered spaces that contained the clients
  - Floors don't interconnect/stairs exit to outside
  - Men, women and children were separated
- Design *Parti*
  - Cross axes at center of campus aligning major buildings
  - Open spaces that use the "captured view" of the site

## Hospital Planning Strategies

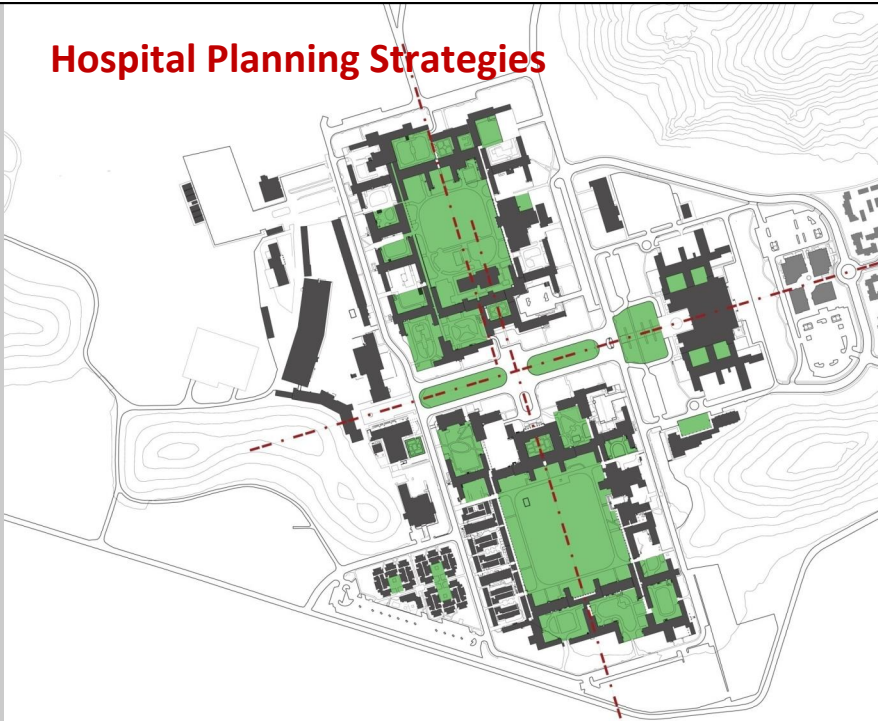

## Transform to a New University



## Transform to a New University

- Initial Planning Goals
  - Beneficial reuse of existing state facility
  - Preserve historic nature of the buildings
- Reuse of Existing Buildings
  - Preserve the historic architectural vernacular
  - Renovate to limit construction costs
- Open Space
  - Network of courtyards that unify the campus
  - Mature landscape as primary feature
- In-fill Construction
  - New in-fill that reinforces the historic fabric
  - Reinforce edges to improve way-finding
- Environmental Practices
  - Build upon the inherent passive sustainable design



## Transform to a New University

### Open Space Comparison



CALIFORNIA STATE UNIVERSITY CHANNEL ISLANDS  
Camarillo, California

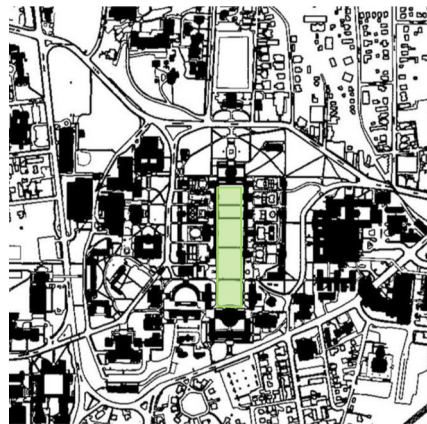

UNIVERSITY OF VIRGINIA  
Charlottesville, Virginia





## Transform to a New University

### Open Space Comparison

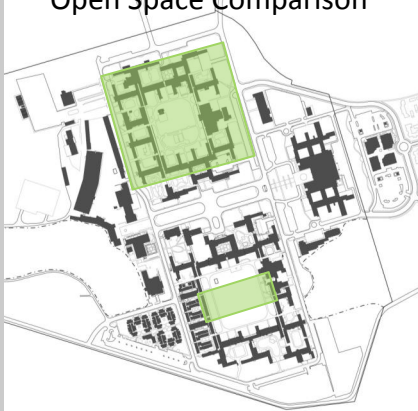

CALIFORNIA STATE UNIVERSITY CHANNEL ISLANDS  
*Camarillo, California*

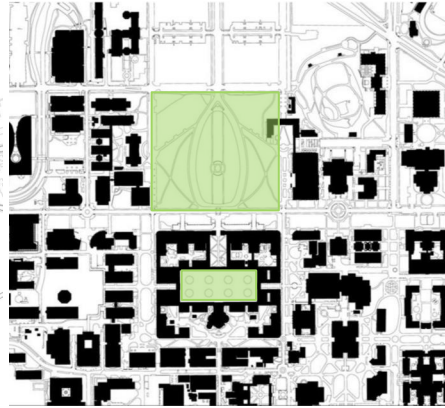

STANFORD UNIVERSITY  
*Palo Alto, California*



## Transform to a New University

### Broome Library (2007)

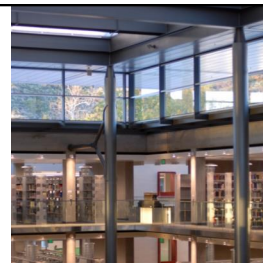

## Transform to a New University

Student Union (2009)



## Lessons Learned/Moving Forward



## Lessons Learned/Moving Forward

- Revised Planning Goals
  - Reflect the intimacy & character of the core campus
  - Express the cultural heritage of the site
- Reuse of Existing Buildings
  - Expensive to renovate
  - Highest & best use - offices
- Open Space
  - Create sequence of open spaces/courtyards that improve way-finding
  - Revise landscape to reflect nature, drought-tolerant plants
- In-fill Construction
  - New construction that creates edges, open spaces
- Environmental Practices
  - Make sustainability demonstrable to campus



## Lessons Learned/Moving Forward

### Concept Planning Approach

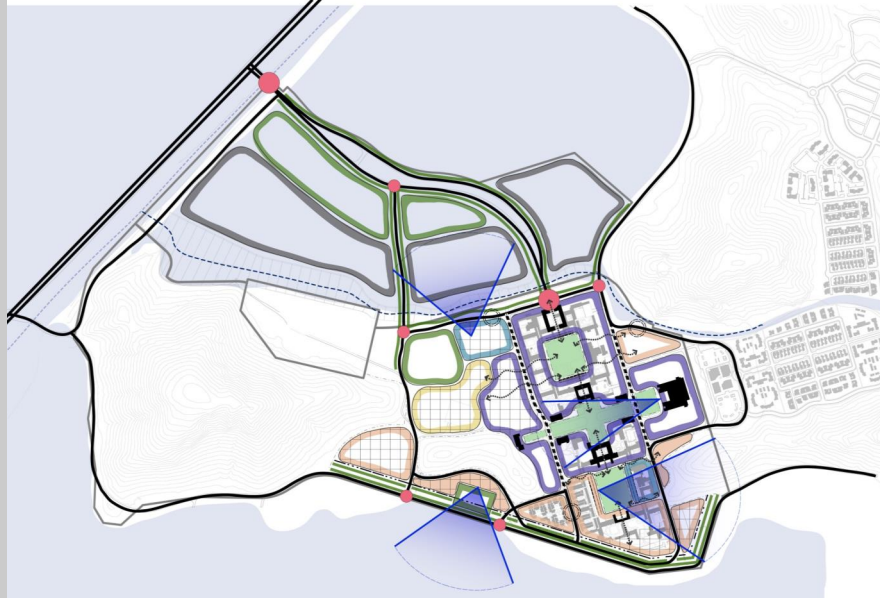



## Lessons Learned/Moving Forward

### Building Type

- New Construction
- Renovation
- Utilitarian
- Un-used



## Lessons Learned/Moving Forward

### Building Use

- Mostly Academic
- Mostly Administrative
- Student Life
- Housing
- Facilities
- Un-used



## Lessons Learned/Moving Forward

Final Master Plan (2011)



## Lessons Learned/Moving Forward

North Hall (2012)





## Lessons Learned/Moving Forward

West Hall (2015)

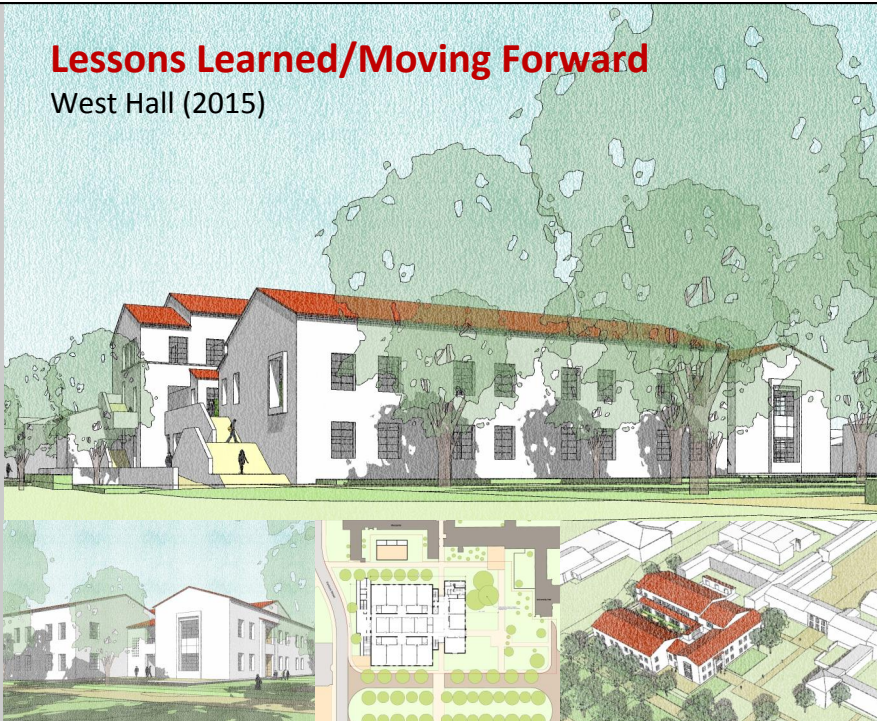

## Lessons Learned/Moving Forward

Events Center

